



## 760 Wilmot Road, FORTH, TAS 7310

RELAXED, PEACEFUL, SELF-SUFFICIENT LIFESTYLE

**20.72 hectares, 51.20 acres**

Situated on approximately 51 acres of land with some cleared fenced paddocks (approx. 7 acres) and bushland, only minutes drive to picturesque Forth Village.

This home was built in 1990 and consists of 3 spacious bedrooms. The main bathroom is 2-way accessible from the main bedroom and consists of a clawfoot bath, walk-in shower, toilet and vanity.

Centrally located modern kitchen is fitted with quality appliances, Gourmet Bakers oven and there is an abundance of storage available.

Separate dining room has gorgeous garden views. Flowing through to the spacious living room with raked timber ceiling and is fitted with a Bellchambers wood heater and has sliding doors leading to the outside area.

Separate office/study perfect for running a home business or the teenagers study area.

Parquet flooring throughout the property.

Double garage with control-a-doors for easy access.

**TYPE:** For Sale

**INTERNET ID:** 83P1674

**SALE DETAILS**

**Offers Over \$850,000**

**CONTACT DETAILS**

**Sales & Rentals**

60 Reibey Street  
ULVERSTONE, TAS  
03 6425 2722

**Andrea Dyson**  
0422 191 489

Outbuildings include 8m x 5m barn, carport, storage, stable, machinery shed, hay shed, potting shed, animal enclosure, workshop and shipping container.

Three spring fed dams and creek offer all-year round water supply along with tank water. Stockyard with loading ramps.

Large variety of established fruit trees on the property making a self-sufficient lifestyle easy.

Close proximity to the Forth River, Leven Canoe Club, Forth Primary School, hotel, bakery, vet and sports facilities.

- Land Area 20.72 hectares
- Building Area: 163.00 square metres
- Bedrooms: 3
- Bathrooms: 1

## HOMESTEAD

Bedrooms	3
Bathrooms	1
House Area	163.00 square metres





















## 760 Wilmot Road, Forth

This floor plan sketch is to be used as a guide only and is not to scale.  
All dimensions listed are approximate.

\*Total approx floor area: 166 sq m (Excl. Double Garage, Covered Dining Area, Covered Verandah)





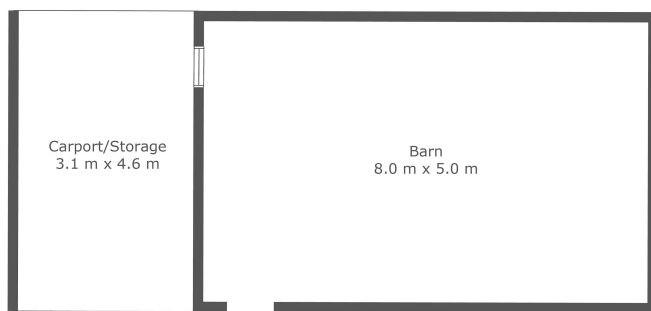

\*NOT IN ACTUAL POSITION

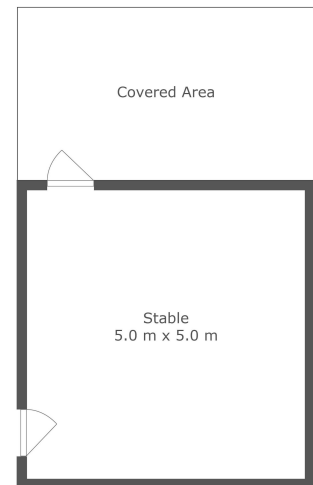

\*NOT IN ACTUAL POSITION

## 760 Wilmot Road, Forth – Barn and Stable

This floor plan sketch is to be used as a guide only and is not to scale.  
All dimensions listed are approximate.

