

**IMPORTANT NOTE**  
THIS PLAN WAS PREPARED FOR A PROPOSED SUBDIVISION TO ACCOMPANY A SUBDIVISION APPLICATION TO COUNCIL AND SHOULD NOT BE USED FOR ANY OTHER PURPOSE. THE DIMENSIONS, AREAS AND TOTAL NUMBER OF LOTS SHOWN HEREON ARE SUBJECT TO FIELD SURVEY AND ALSO TO THE REQUIREMENTS UNDER ANY RELEVANT LEGISLATION. IN PARTICULAR, NO RELIANCE SHOULD BE PLACED ON THE INFORMATION ON THIS PLAN FOR ANY FINANCIAL DEALINGS INVOLVING THE LAND. ANY UTILITY INFORMATION SHOWN HEREON SHOULD NOT BE RELIED UPON FOR ANY PURPOSE. A FULL DIAL BEFORE YOU DIG SEARCH MUST BE MADE BY CONTACTING DSYD ON PH:1100 OR WWW.1100.COM.AU. THIS NOTE IS AN INTEGRAL PART OF THIS PLAN.

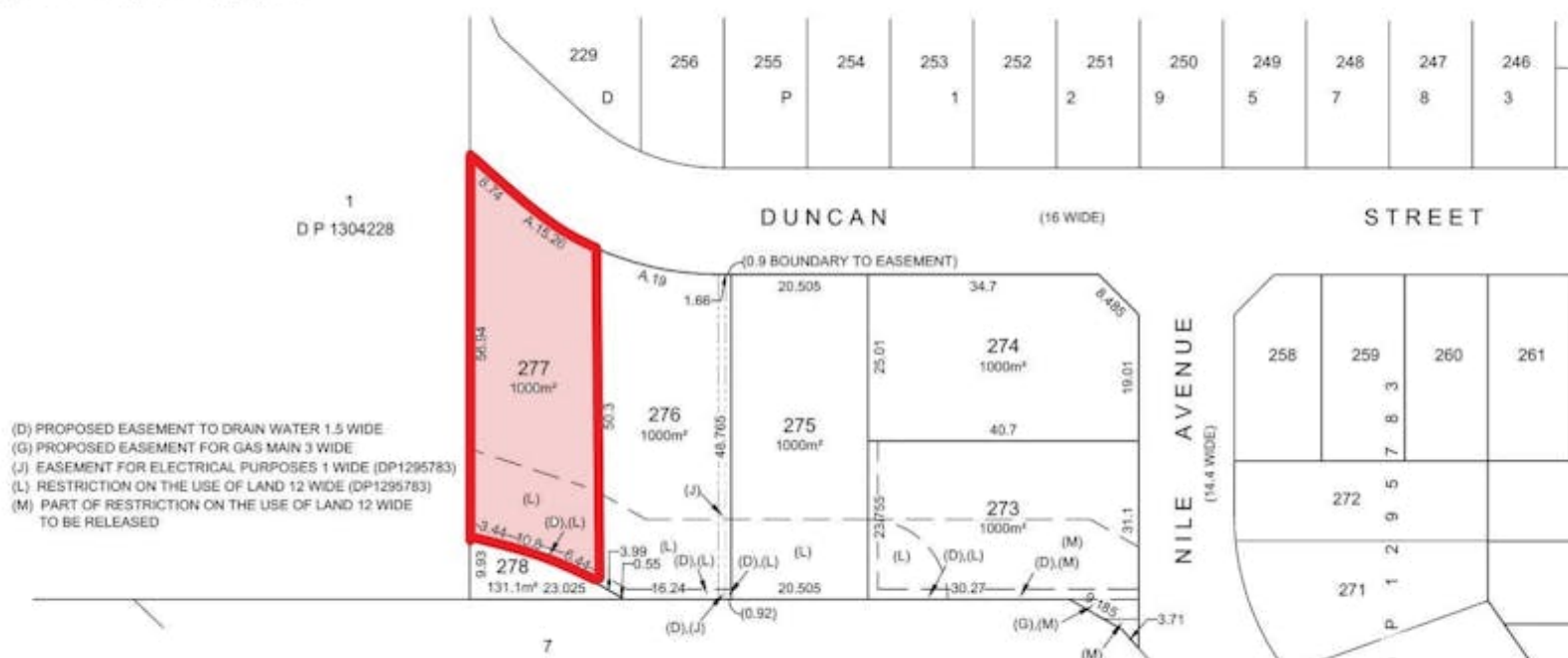

## Health Road, LEPPINGTON, NSW 2179

Rare 1,000sqm Opportunity in Prime Leppington

**1,000.00 square metres,**

Land Anticipated to Register Q2 2026

A fantastic chance to secure a spacious 1,000sqm parcel in the heart of Leppington a size that's becoming harder and harder to find in this tightly held area. Whether you're planning your next investment or envisioning a home with room to breathe, this block delivers the space you want without pushing you out to the fringes of Sydney.

Set within an established and fast-growing neighbourhood, you're surrounded by quality schools, parks, shopping, and everyday conveniences that make Leppington one of the most sought-after pockets in the South West.

Features:

\* Build your dream home with the builder you prefer

**TYPE:** For Sale

**INTERNET ID:** 98P2104

**SALE DETAILS**

**\$1,300,000 -  
\$1,400,000**

**CONTACT DETAILS**

**Leppington**

Shop 4.04 / 5 Emerald Hills  
Boulevard  
LEPPINGTON, NSW  
02 8797 3177

**Frank Polistina**  
0407 406 673

- \* Set within a peaceful, family-oriented pocket
- \* Moments from parks, public transport and key amenities
- \* Just 600m to Willowdale Shopping Centre
- \* Approximately 300m from Leppington Anglican School
- \* Only 1km to Amity College, Leppington
  - Land Area 1,000.00 square metre

