



12 Culverston Avenue, DENHAM COURT, NSW 2565

Grand Family Estate on 2.5 Acres | Resort-Style Living in a Prestigious Cul-de-Sac

Set on approximately 2.5 acres in one of Denham Court's most prestigious and tightly held cul-de-sacs, this remarkable residence offers a rare combination of space, privacy and resort-inspired living. Positioned behind established gardens and a sweeping circular driveway, the home delivers an impressive lifestyle opportunity for large families, multi-generational living or those seeking a private acreage retreat close to everyday conveniences.

Designed with both functionality and entertaining in mind, the residence showcases expansive interiors, multiple living zones and an incredible indoor pool pavilion, creating a home unlike any other in the area.

Property Highlights

- Approx. 2.5 acres of beautifully maintained land
- Solid brick veneer render granosite residence with concrete panels upstairs exceptional privacy
- Six spacious bedrooms including a luxurious master retreat

The particulars contained herein are supplied for information only and shall not be taken as a representation in any respect on the part of the vendor or its agent. Interested parties should contact the nominated person or office for full and current details.

TYPE: For Sale

INTERNET ID: 98P2176

SALE DETAILS

[Contact Agent](#)

CONTACT DETAILS

Leppington

Shop 4.04 / 5 Emerald Hills
Boulevard

LEPPINGTON, NSW

02 8797 3177

David D'alfonso

0478211608

- Multiple living areas, home cinema, billiards room, music room and home office
- Gourmet kitchen with stone benchtops, oversized island and gas cooking
- Indoor heated swimming pool pavilion for year-round enjoyment
- Striking indoor water garden feature
- Multiple alfresco entertaining areas and elevated balconies
- Established gardens, orchards and expansive open lawns
- Detached workshop/shed, triple garage and extensive off-street parking

Conveniently located just minutes from Ed Square Shopping Centre, Edmondson Park Train Station, quality schools, parks and major transport links.

A truly unique opportunity to secure one of Denham Court's most significant lifestyle properties on approximately 2.5 acres.

Other features: Close to Schools, Close to Shops, Close to Transport, Pool

- Land Area 2.5 acres
- Building Area: 680.00 square metres
- Bedrooms: 6
- Bathrooms: 6
- Car Parks: 4
- Ensuite





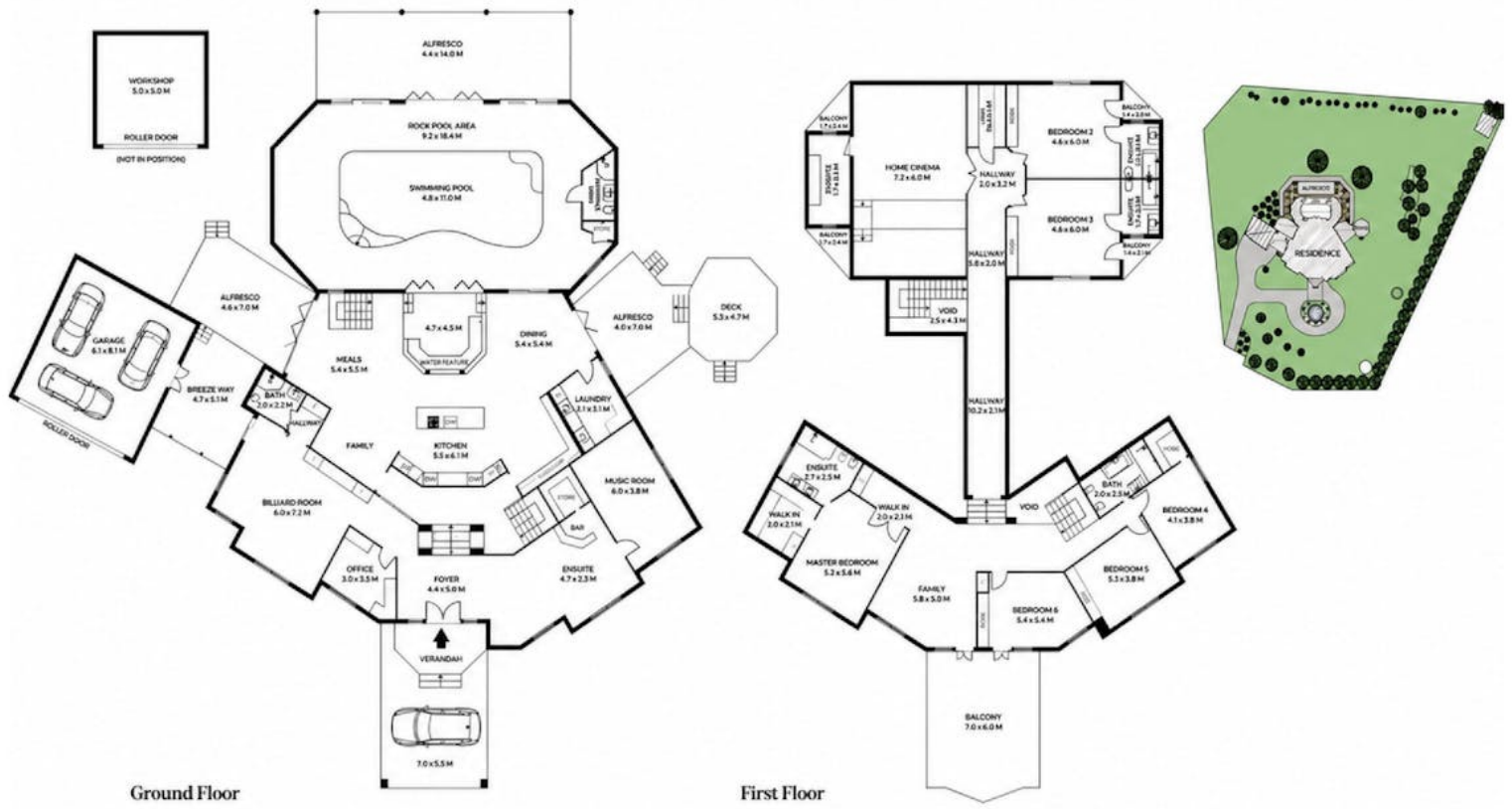

12 Culverston Avenue, Denham Court

Scales in metre. Indicative only. Dimensions are approximate. All information contained in here is gathered from sources we believe to be reliable. However we cannot guarantee its accuracy and interested persons should rely on their own enquiries.