



## 22 Bass Street, TAMWORTH, NSW 2340

### Last Remaining Industrial Land in Taminda

Positioned in the highly sought after industrial precinct of Taminda, 22 Bass Street offers a rare opportunity to secure a substantial parcel of land primed for future development (STCA).

Set on approximately 8,734 sqm, the property presents excellent scope for redevelopment, expansion, or land banking within a well established industrial hub.

Property highlights include:

- Generous 8,734 sqm\* landholding
- Zoned E4 General Industrial
- Existing Industrial shed 680 sqm\* in total plus a two bedroom cottage
- Established industrial location with strong surrounding businesses
- Flexible site suitable for a range of industrial or commercial uses (STCA)
- Opportunity to redevelop, occupy, or invest for future growth

The particulars contained herein are supplied for information only and shall not be taken as a representation in any respect on the part of the vendor or its agent. Interested parties should contact the nominated person or office for full and current details.

**TYPE:** Auction

**INTERNET ID:** L40076358

#### **AUCTION DETAILS**

6:00pm, Thursday May 7th, 2026

#### **CONTACT DETAILS**

**Elders Real Estate  
Tamworth**  
247 Peel Street  
Tamworth, NSW  
02 6766 1666

**Malcolm Campbell**  
0418499764

With increasing demand for industrial land in Taminda, this property represents a strategic acquisition for developers, investors, and owner-occupiers alike.

Contact Malcolm Campbell on 0418 499 764 for an Information Memorandum.

\* (approx.)

- Land Area 8,734.00 square metres
- Commercial Type:
- Building Area: 680.00 square metres
- Zoning: E4 General Industrial





# 22 Bass Street, Taminda

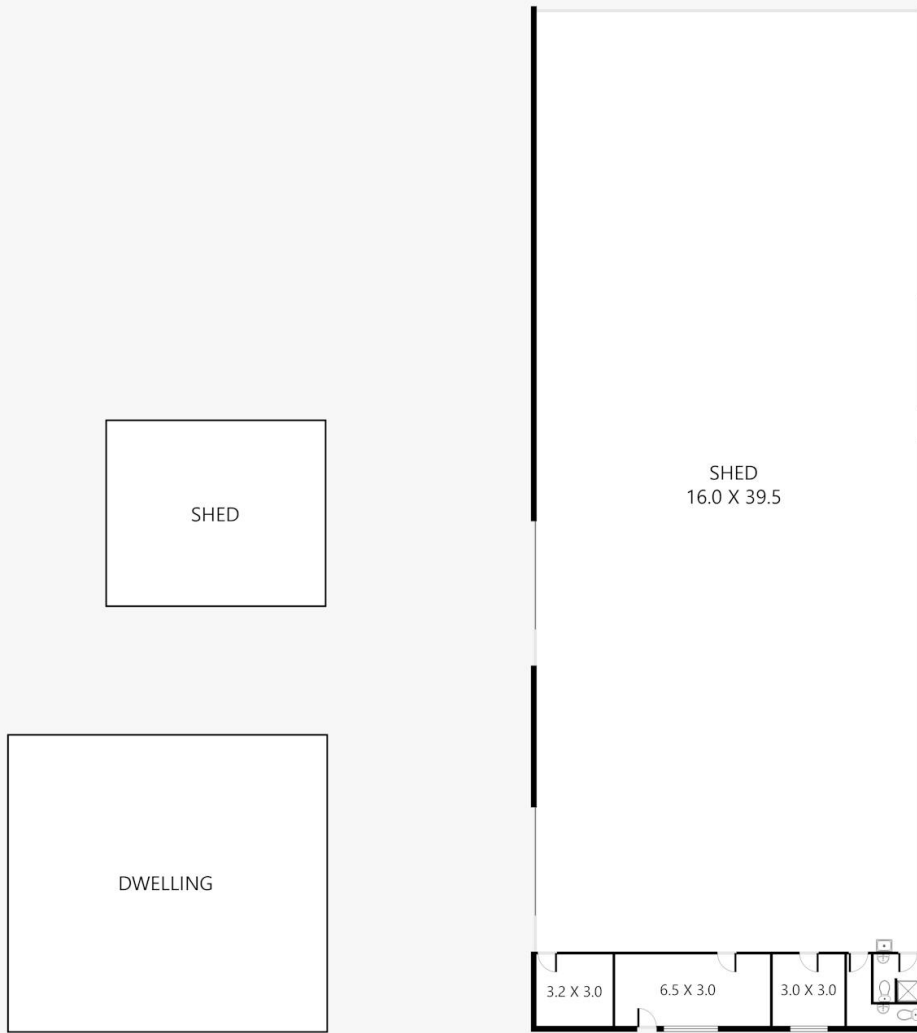

Disclaimer: This plan is not to scale and is for illustrative purposes only. Measurements are approximate only. Placement of doors, windows and all other items are approximate. Elders gives no guarantee or warranty as to the accuracy or layout. Any person using this information should rely on their own enquiries.