



14 Ashfield Street, SANDY BAY, TAS 7005

Fully furnished apartment in prime location

Ideal for investors and university students, this sunny and contemporary apartment in the heart of Sandy Bay offers a convenient, low-maintenance lifestyle with all essentials within easy reach. With a lease in place until the end of 2025 generating \$550 per week and reliable tenants, this property presents a secure investment opportunity.

The inviting open-plan interior boasts trendy flooring and stylish touches throughout.

TYPE: Sold

INTERNET ID: R23917330

SALE DETAILS

\$595,000 - \$615,000

The particulars contained herein are supplied for information only and shall not be taken as a representation in any respect on the part of the vendor or its agent. Interested parties should contact the nominated person or office for full and current details.

The well-appointed kitchen is equipped with modern appliances, extensive countertops and ample cabinetry. Large windows flood the generous living and dining area with natural light, capturing picturesque vistas of the mountain overlooking Sandy Bay.

The apartment includes two spacious bedrooms, both with built-in wardrobes, and a bathroom that features a compact laundry. Ample storage throughout enhances practicality, including a wall-mounted entertainment unit for your TV and Wi-Fi. Additional features include an NBN connection for fast internet and an allocated undercover single car park.

Just a short walk from the centre of Sandy Bay, you'll find Coles, Woolworths, an array of restaurants, cafes, and bus stops right at your doorstep. Short Beach, local parks, and the Sandy Bay Bowls Club are also within easy reach, while the University of Tasmania is just a gentle stroll away and Hobart CBD only 2kms. This fully furnished apartment is ready for its next owners to enjoy an ultra-low maintenance and convenient lifestyle within one of Hobart's most sought-after suburbs.

- Land Area 62.00 square metres
- Building Area: 62.00 square metres
- Bedrooms: 2
- Bathrooms: 1
- Single carport

CONTACT DETAILS

Elders Hobart
5 Victoria Street
HOBART, TAS
03 6220 6999

Todd Stevenson
0438 295 604







SANDY BAY
Unit 7/14 Ashfield Street
House Area : 62sqm (6.67sq)
Outbuilding Area : 13sqm (1.3sq)

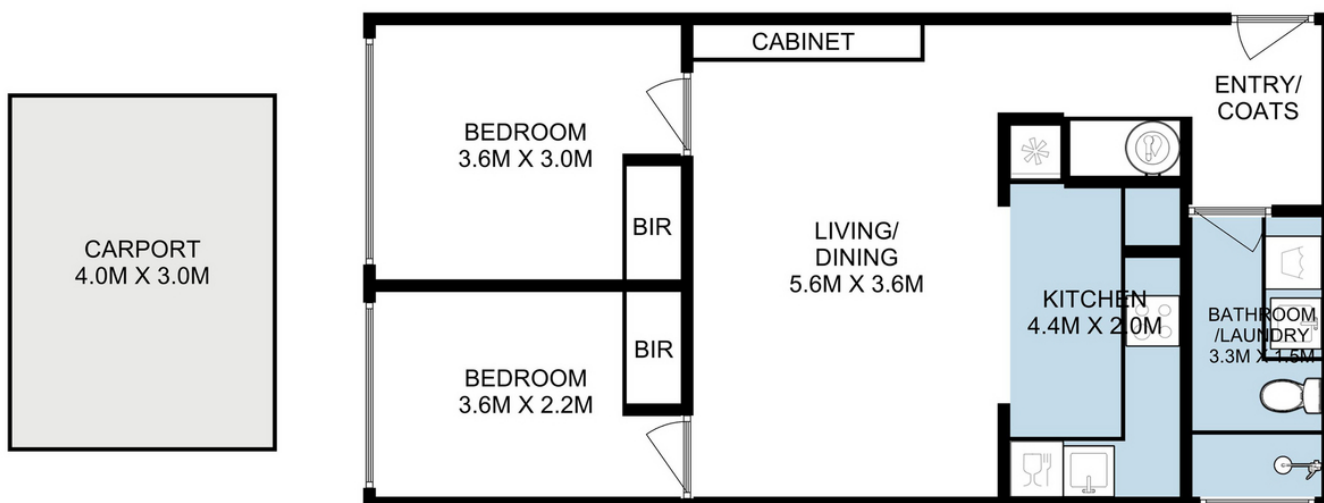

IMPORTANT: measurements are approximate-interested parties need to verify