



303 Kregors Road, GORDON, TAS 7150

A secluded haven with breathtaking views

***Existing dwellings plus Building Approval for new dwelling and shed included ***

Escape to a serene and self-sufficient lifestyle with this remarkable 20.3Ha (50 Acres) parcel of land, where lush rainforest, towering tree ferns, and cleared spaces create a truly unique sanctuary. Offering complete privacy and an off-grid retreat, this property is ideal for those seeking a tranquil escape while remaining connected to nearby

TYPE: For Sale

INTERNET ID: R24463720

SALE DETAILS

Offers over \$825,000

The particulars contained herein are supplied for information only and shall not be taken as a representation in any respect on the part of the vendor or its agent. Interested parties should contact the nominated person or office for full and current details.

townships. This is a property that needs to be experienced to be appreciated!

- **Idyllic Off-Grid Living** â## Featuring a one-bedroom studio and temporary accommodations, including a caravan under a large carport, this property is designed for those who appreciate sustainable, low-impact living. A composting toilet, an outdoor wood-heated bath, and a fire pit enhance the rustic charm.

- **Self-Sufficiency & Natural Beauty** â## Grow your own produce with a fenced vegetable garden and a stone-built hothouse, perfectly suited for year-round cultivation. A winter dam and extensive tree fern groves add to the property's natural appeal.

- **Unparalleled Views & Tranquil Surroundings** â## Enjoy uninterrupted water vistas stretching from Simpsons Point to the Bruny Island Isthmus and beyond to the Tasman Peninsula, all from your own private sanctuary.

- **Prime Location with Accessibility** â## Just a short drive to Middleton's General Store, the acclaimed Peppermint Bay Restaurant and Mewstone Winery while Cygnet's vibrant community is only 25 minutes away. For city conveniences, Hobart is within a 50-minute reach.

With Development Application and Building Approval in place, you can start creating your dream escape immediately or tailor the plans to suit your vision.

A large selection of Timber and Stone is already onsite for the build that can be purchased separately.

Don't miss this very rare opportunityâ##contact Rorie today to explore this one-of-a-kind property!

- Land Area 50 acres
- Building Area: 70.00 square metres
- Bedrooms: 1
- Bathrooms: 1
- Car Parks: 5
- Single carport

CONTACT DETAILS

Elders Hobart
5 Victoria Street
HOBART, TAS
03 6220 6999

Andrew Karimalis
0411717069









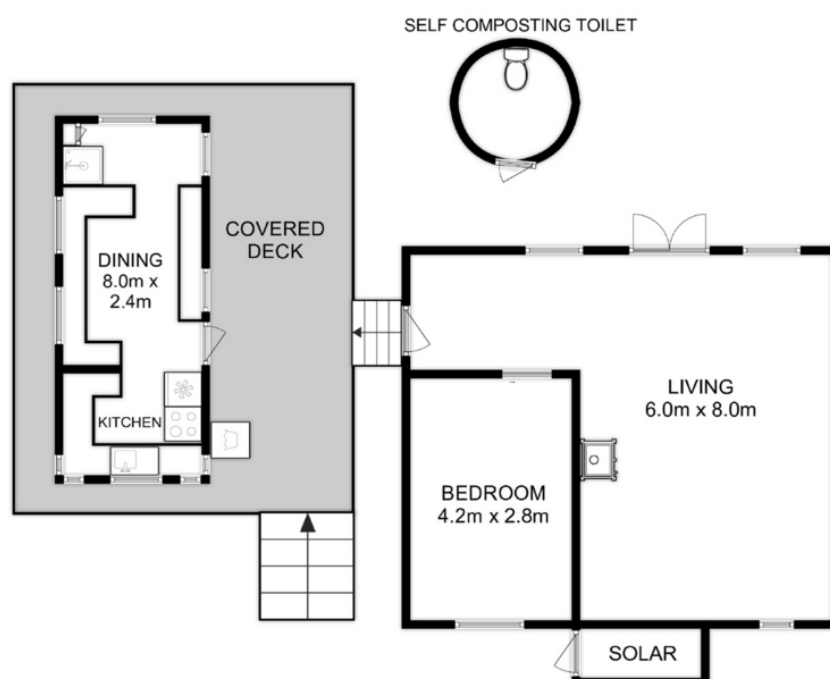

Total Approx. Floor Area : 70 sqm

All measurements are internal and approximate.
This plan is a sketch for illustration, not valuation.
Produced by Open2view.com