



74 Alexander Street, SANDY BAY, TAS 7005

Renovated family home nestled in nature

Lovingly restored and thoughtfully updated, this beautifully renovated c1920 residence blends timeless character with modern family functionality. Nestled within a lush native garden and backing onto a tranquil bushland reserve, it offers a lifestyle of comfort, versatility, and sustainability.

Step inside to discover a home rich in period charm and craftsmanship. The welcoming

TYPE: Sold

INTERNET ID: R24489869

SALE DETAILS

Offers over \$1,150,000

entry foyer and hallway feature striking blackbutt overlay flooring, leading to three spacious double bedrooms with pure wool carpets. A sleek, modern bathroom with premium fittings and heated towel rails adds a touch of everyday luxury.

At the heart of the home, the open-plan kitchen, living, and dining zone is designed for both entertaining and everyday ease. Enjoy bespoke joinery, double-glazed windows, and a commercial-grade all-stainless-steel kitchen complete with a 90cm Smeg oven and walk-in pantry—perfect for the home chef.

Downstairs, a semi self-contained area offers the ideal space for teenagers, guests, or extended family. With its own lounge area, double bedroom, modern bathroom, and ample storage, it's a flexible space that adapts to your lifestyle.

This home is as practical as it is beautiful, with mains gas hydronic heating, a 5kW solar system, LED lighting, NBN connectivity, and extensive re-plumbing and insulation upgrades.

Outdoors, enjoy a covered front porch, a spacious timber deck with water and treetop views, and a productive garden featuring fruit trees, veggie patch, and a beautiful bespoke studio—perfect for creative or professional pursuits.

- Land Area 704.00 square metres
- Building Area: 188.00 square metres
- Bedrooms: 4
- Bathrooms: 2
- Car Parks: 3

CONTACT DETAILS

Elders Hobart
5 Victoria Street
HOBART, TAS
03 6220 6999

Anne Boman
0409 571 542











GROUND FLOOR

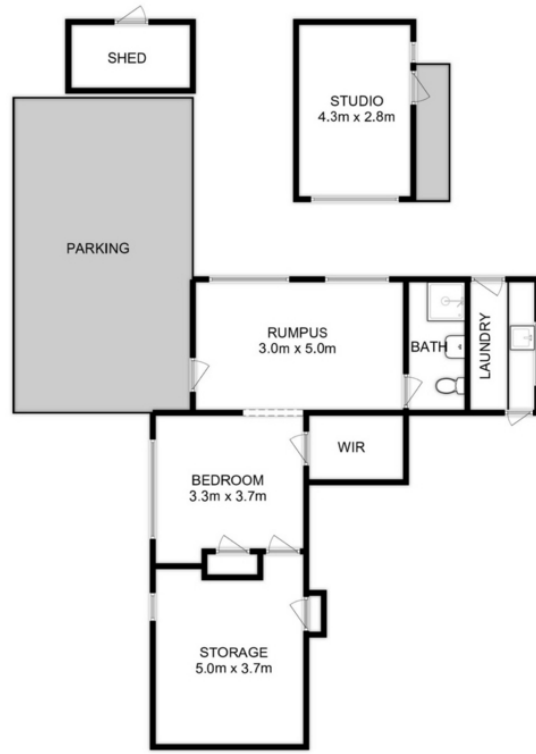

LOWER GROUND FLOOR



Total Approx. Floor Area : 188 sqm
 Total Approx. Outbuilding Area : 17 sqm

All measurements are internal and approximate.
 This plan is a sketch for illustration, not valuation.
 Produced by Open2view.com