



1 Hookey Place, ROKEBY, TAS 7019

Invest or nest

Positioned in a quiet, well-established pocket of Rokeby, 1 Hookey Place presents a fantastic opportunity for first home buyers or savvy investors.

This solid brick veneer home features three comfortable bedrooms, including a spacious master bedroom that easily accommodates a king bed. The main bedroom offers built-in wardrobes and is serviced by an updated central family bathroom and a

TYPE: Sold

INTERNET ID: R24646278

SALE DETAILS

Offers over \$480,000

separate toilet for added convenience.

The light-filled living area is welcoming year-round, complete with a reverse cycle heat pump for efficient heating and cooling. The home is warm and sunny throughout. The combined kitchen and dining space is functional and well-equipped with a new induction oven, dishwasher, and stunning Tasmanian oak flooring, offering practicality for everyday living.

A separate laundry and hallway linen cupboard add to the layout's convenience, while new carpet in the bedrooms and a freshly painted interior give the home a refreshed feel.

Outside, the home boasts excellent street appeal with a generously sized, landscaped front yard. The fully fenced backyard offers plenty of space and privacy, perfect for families with children or pets. Enjoy entertaining on the large covered deck, or make the most of the multiple garden sheds, under-house storage, and a double carport providing ample off-street parking.

For those with a green thumb, the backyard features developing fruit trees, including two double-grafted apple trees with four varieties, cherry, apricot, fig, lemon, lime, orange, quince, feijoa, raspberries, thornless blackberries, two plums, passionfruit, and a double-grafted peach/nectarineâ##creating your own private orchard.

Technology and infrastructure are covered too, with FTTP NBN for fast internet access and a new switchboard recently installed. Additional updates include new blinds throughout for comfort and privacy.

Nestled in a quiet street in a friendly neighbourhood, the property is surrounded by large parks and reserves that attract native birdlife including galahs, rosellas, cockatoos, and corellas. You're just minutes from beaches, local schools, parks, Glebe Hill Village, and Shoreline Plaza, with both Hobart CBD and the airport easily accessible.

- Land Area 711.00 square metres
- Building Area: 100.00 square metres
- Bedrooms: 3
- Bathrooms: 1
- Car Parks: 2
- Double carport
- Floorboards

CONTACT DETAILS

Elders Hobart
5 Victoria Street
HOBART, TAS
03 6220 6999

Rose Allie
0426 877 789







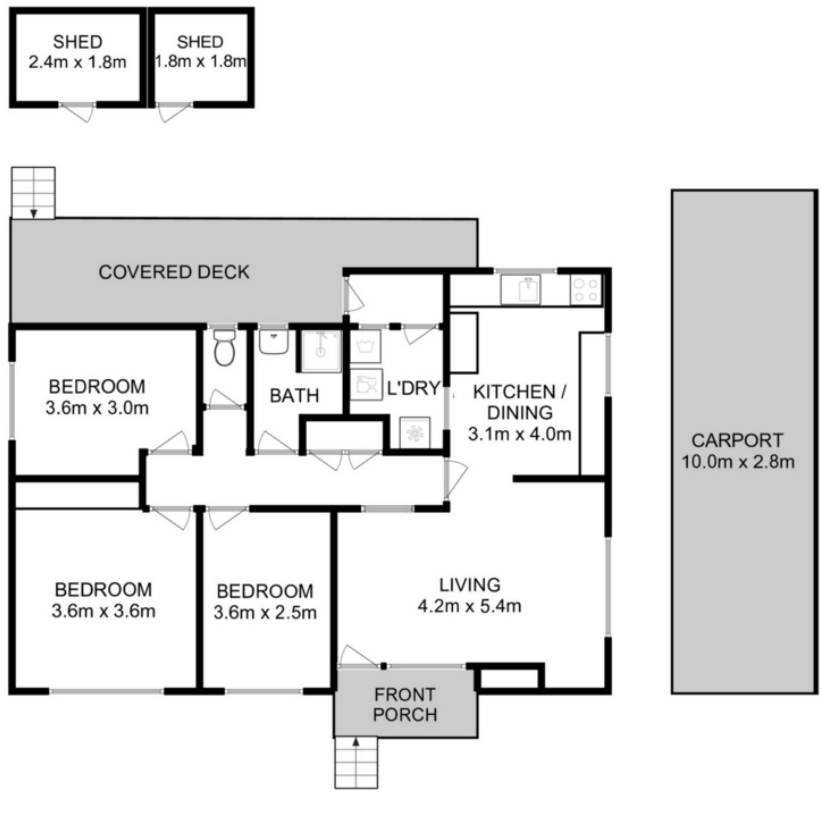

Total Approx. Floor Area : 100 sqm
Total Approx. Outbuilding Area : 8 sqm

All measurements are internal and approximate.
This plan is a sketch for illustration, not valuation.
Produced by Open2view.com