

38-40 Bayview Road, LAUDERDALE, TAS 7021

Coastal living on large double block

Enjoying a prized position just moments' walk from the Lauderdale Beach, this light-filled brick residence presents an exceptional opportunity within the sought-after beachside suburb of Lauderdale. Set across a substantial double block of 1,340 sqm (approx.), the property offers generous accommodation, multiple outdoor living zones, and a converted shed that provides valuable additional space for hobbies, storage or recreation.

TYPE: Sold

INTERNET ID: R24712151

SALE DETAILS

Offers over \$895,000

The home combines character with modern touches, featuring an updated kitchen and bathroom that bring style and practicality to everyday living. The spacious floor plan comprises three generously sized bedrooms, each with built-in robes, a welcoming kitchen and dining area, and a spacious formal living room warmed by a woodfire or reverse-cycle air conditioner for year-round comfort. Expansive windows capture leafy garden outlooks and fill the interiors with natural warmth and light, with double glazing on the south side ensuring energy efficiency. Solar panels further enhance the home's appeal, helping to reduce ongoing power costs.

Outdoors, the property excels as an entertainer's haven. A fully enclosed patio provides the perfect all-weather retreat, while the covered barbecue area is ideal for relaxed gatherings with family and friends. The gardens are established with fruit trees and native plantings, creating a private, tranquil setting that reflects the coastal environment.

The extensive block provides abundant space for parking boats, caravans, or multiple vehicles, while still offering plenty of room for children and pets to enjoy. A converted shed/utility room adds further versatility for a range of uses and adjoins a workshop for added functionality. Additional infrastructure includes a single carport and a separate 6m x 3m shed on a concrete slab, providing excellent storage and utility options.

Perfectly positioned to embrace the relaxed coastal lifestyle, this home is just a short stroll to Lauderdale Beach and within easy reach of local cafes, shops, and services. Offering space, versatility, and an enviable location, 38-40 Bayview Road is a rare find in one of Hobart's most desirable seaside communities.

- Land Area 1,340.00 square metre
- Building Area: 183.00 square metres
- Bedrooms: 3
- Bathrooms: 1
- Car Parks: 5
- Single carport

CONTACT DETAILS

Elders Hobart
5 Victoria Street
HOBART, TAS
03 6220 6999

Rose Allie
0426 877 789









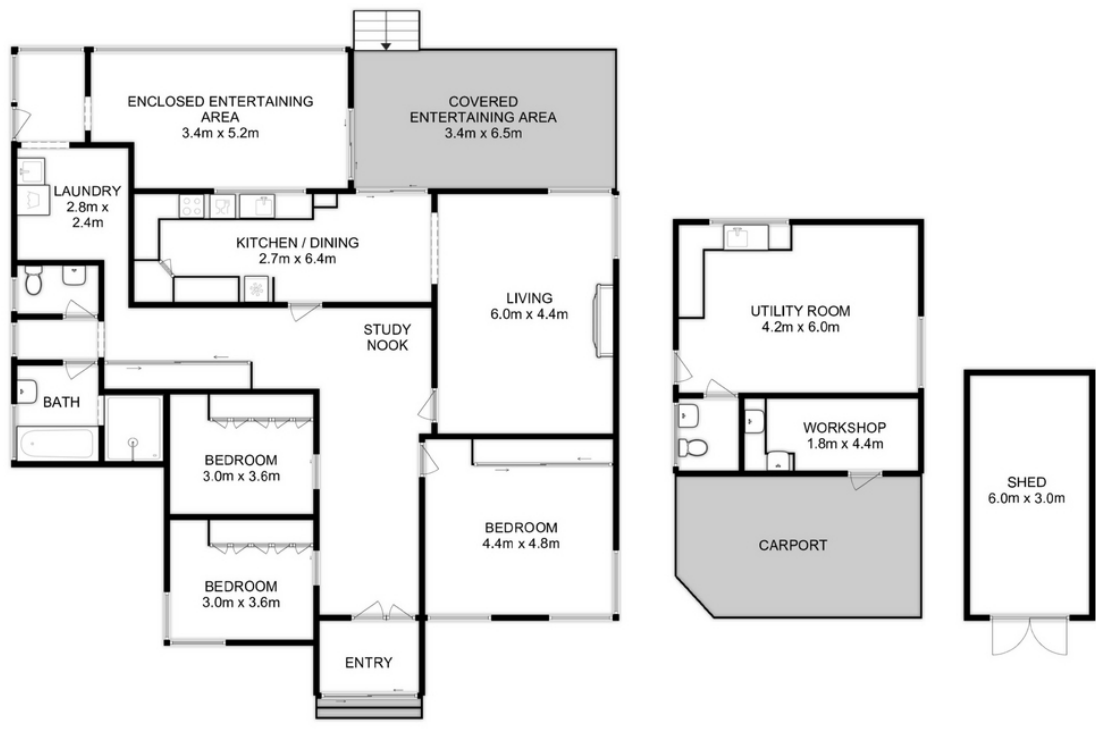

Total Approx. Floor Area : 183 sqm
Total Approx. Outbuilding Area : 58 sqm



All measurements are internal and approximate.
This plan is a sketch for illustration, not valuation.
Produced by Open2view.com