



27 Esplanade, SWANSEA, TAS 7190

Wake up with the sunrise daily

Experience the best of coastal living in this immaculate, near-new home, built in 2021 and positioned to take full advantage of breathtaking 180-degree views over Great Oyster Bay and the iconic Freycinet Peninsula.

Set on a level allotment for low-maintenance living, this beautifully appointed 3-bedroom, 2-bathroom residence offers the perfect blend of style, comfort, and

TYPE: For Sale

INTERNET ID: R24735278

SALE DETAILS

\$1,550,000

The particulars contained herein are supplied for information only and shall not be taken as a representation in any respect on the part of the vendor or its agent. Interested parties should contact the nominated person or office for full and current details.

convenience.

Inside, you'll find quality finishes throughout including stone benchtops in the modern kitchen, hybrid flooring in the living areas, plush carpet in the bedrooms, and sleek tiles in the bathrooms and laundry. The master suite features an ensuite and walk-in robe, providing a private retreat.

Entertain year-round in the fully enclosed front entertainment area with commercial-grade floor to ceiling windows, designed to maximise the spectacular views and natural light. The attached garage offers internal access, and outside, the landscaped yard includes raised garden beds and a 2m x 2m poly garden shed.

Located just minutes from the town centre, hospital, school, and shopping, this home delivers premium living with minimal upkeep no expense has been spared.

- Land Area 484.00 square metres
- Building Area: 189.00 square metres
- Bedrooms: 3
- Bathrooms: 2
- Car Parks: 2
- Single garage

CONTACT DETAILS

Elders Hobart
5 Victoria Street
HOBART, TAS
03 6220 6999

Leanne Dann
0417 128 048









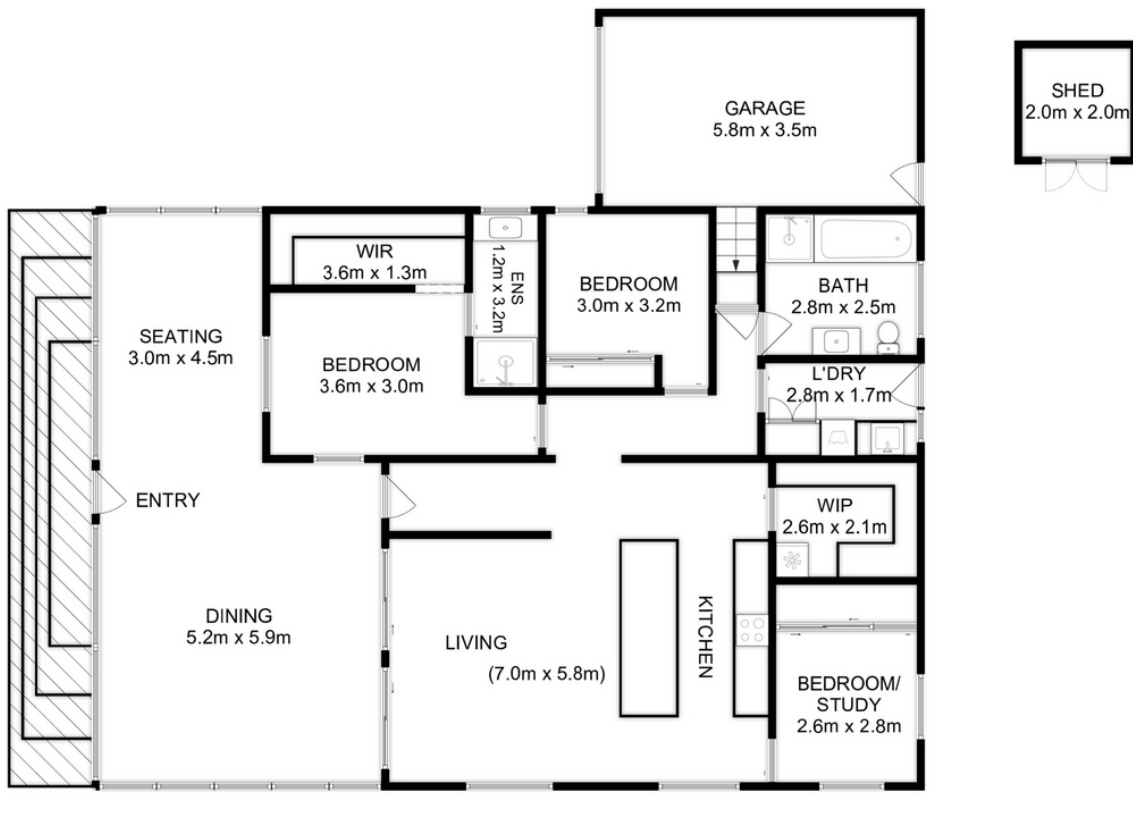

Total Approx. Floor Area (inc. Garage): 189 sqm

All measurements are internal and approximate.
This plan is a sketch for illustration, not valuation.
Produced by Open2view.com