



289-291 Main Road, GLENORCHY, TAS 7010

High-Exposure Industrial Opportunity With Significant Hardstand

The particulars contained herein are supplied for information only and shall not be taken as a representation in any respect on the part of the vendor or its agent. Interested parties should contact the nominated person or office for full and current details.

Elders Commercial is pleased to present this outstanding high-exposure industrial leasing opportunity in the heart of Glenorchy's tightly held commercial precinct.

Positioned on a prominent site, this brand new two-bay concrete panel warehouse offers a building area of 117 sqm* with an expansive asphalt hardstand and car park of 970 sqm*. The property boasts exceptional frontage to the Main Road, providing high visibility and excellent signage opportunities.

Functional and secure, the property lends itself to a wide range of uses and includes the potential to incorporate the vehicle hoists as part of the tenancy lease.

Key highlights include:

- Brand new 117 sqm* two-bay concrete panel warehouse
- Expansive 970 sqm* site area, including hardstand and car parking
- High-profile site with excellent signage exposure
- Opportunity to include hoists in lease
- Secure, versatile, and accessible site

A practical offering in a well-connected location, suited to operators seeking modern warehouse space with excellent access and on-site parking.

For more information or to arrange an inspection, please contact George Burbury.

*Approx

- Commercial Type:
- Building Area: 117.00 square metres
- Zoning: Commercial

TYPE: For Lease

INTERNET ID: SU114422

RENTAL DETAILS

Rent / Lease:

[Contact Agent](#)

CONTACT DETAILS

SURGA Hobart

5 Victoria Street

HOBART, TAS

03 6220 6999

George Burbury

0408 333 523



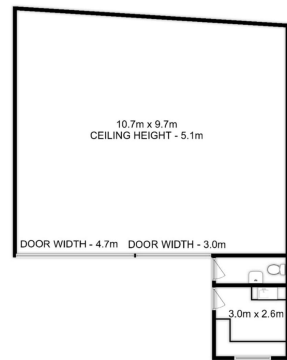
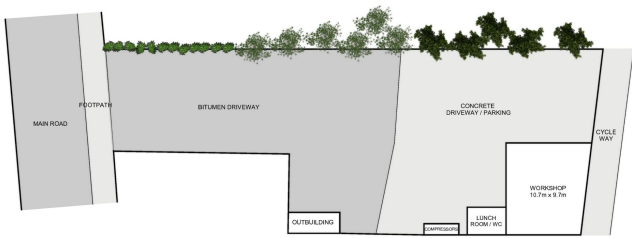

SITE PLAN

All measurements are internal and approximate.
This plan is a sketch for illustration, not valuation.
Produced by Open2view.com

Total Approx. Building Area : 117 sqm

All measurements are internal and approximate.
This plan is a sketch for illustration, not valuation.
Produced by Open2view.com