



1 Hawkesford Road, CAMBRIDGE, TAS 7170

Prime Automotive or Industrial Facility – Airport Precinct

The particulars contained herein are supplied for information only and shall not be taken as a representation in any respect on the part of the vendor or its agent. Interested parties should contact the nominated person or office for full and current details.

Elders Commercial Tasmania is pleased to present an exceptional leasing opportunity in one of Southern Tasmania's most strategic locations.

Positioned just moments from Hobart International Airport and seamlessly connected to major arterial routes, this versatile property offers outstanding functionality and profile. With significant hardstand, generous access, and excellent exposure to the steady stream of traffic to and from the airport, it is ideally suited to a range of automotive-related uses - from hire car depot operations to mechanical repairs and fleet servicing.

Beyond its automotive appeal, the property's flexible layout make it equally well-suited to a broad range of industrial uses. The combination of open yard space and adaptable building areas allows for applications such as equipment hire and servicing, logistics and freight handling, light manufacturing, warehousing, or trade supply operations.

Whether you're seeking a high-profile base for an established operation or a location with superb connectivity to launch a new venture, 1 Hawkesford Road delivers unmatched convenience and potential.

- Land Area 4,769.00 square metres
- Commercial Type:
- Building Area: 485.00 square metres

**TYPE:** For Lease

**INTERNET ID:** SU114514

**RENTAL DETAILS**

**Rent / Lease:**

[Contact Agent](#)

**CONTACT DETAILS**

**SURGA Hobart**

5 Victoria Street

HOBART, TAS

03 6220 6999

**George Burbury**

0408 333 523





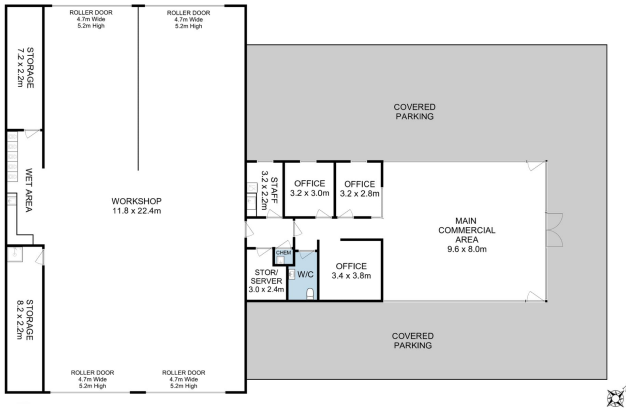

Total Approx. Floor Area : 485 sqm

All measurements are internal and approximate.  
This plan is a sketch for illustration, not valuation.  
Produced by OpenView.com