

7 Cessna Way, CAMBRIDGE, TAS 7170

High Quality Warehouse in Popular Cambridge

The particulars contained herein are supplied for information only and shall not be taken as a representation in any respect on the part of the vendor or its agent. Interested parties should contact the nominated person or office for full and current details.

Position your business in the heart of Southern Tasmania's premier industrial precinct with this high-quality warehouse unit in sought-after Cambridge.

Unit 15 offers a versatile and functional space ideally suited to a range of uses, from trade-based operators to logistics or storage. The property benefits from excellent vehicle access, on-site parking and a modern tilt-up construction with internal amenities.

Key Features:

- 187 sqm* of clear-span warehouse plus 44 sqm* of mezzanine and 21 sqm* of office space
- Motorised roller door access with 5.3m* clearance
- Full bathroom amenities including shower and kitchenette
- Excellent natural light with high-bay LED lighting

Located just minutes from Hobart Airport and only 15 minutes* from the Hobart CBD, this tightly-held location continues to attract strong demand from local and national operators.

For further information or to arrange an inspection contact Liam Coyle 0407 868 370.

*Approximate

- Land Area 257.00 square metres
- Commercial Type:
- Building Area: 252.00 square metres
- Zoning: Light Industrial

TYPE: For Lease

INTERNET ID: SU114606

CONTACT DETAILS

SURGA Hobart

5 Victoria Street
HOBART, TAS
03 6220 6999

Liam Coyle

0407 868 370



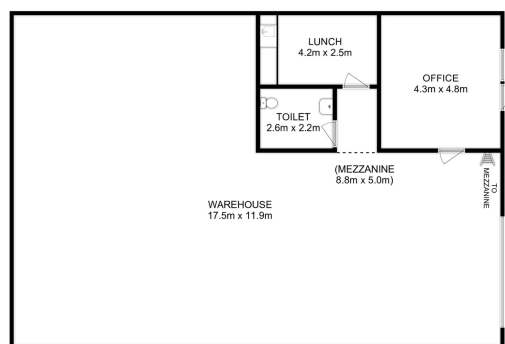

Total Approx. Floor Area : 208 sqm

All measurements are internal and approximate.
This plan is a sketch for illustration, not valuation.
Produced by Open2view.com