



BRUCE HIGHWAY RETAIL / OFFICE AVAILABILITY

Strategically located near Emmaus College, Discovery Parks, and the Red Hill

TYPE: For Lease
INTERNET ID: SUG6041
RENTAL DETAILS
Rent / Lease:
\$27,750PA + GST +

The particulars contained herein are supplied for information only and shall not be taken as a representation in any respect on the part of the vendor or its agent. Interested parties should contact the nominated person or office for full and current details.

Homemaker Centre, this site is ideal for businesses seeking visibility and accessibility.

Available Tenancy:

4A 111 sqm versatile space suitable for a range of uses, including retail, fitness, professional office, or medical services.

For further details or to arrange an inspection, contact Jonathon Offord today.

- Commercial Type:
- Zoning: Commercial

OUTGOINGS

CONTACT DETAILS

Elders Commercial

Rockhampton

Level 2/102 Bolsover St

Rockhampton City, QLD

07 4921 2347

Jonathon Offord

0488 270 174



379 Yaamba Road, **Park Avenue** 

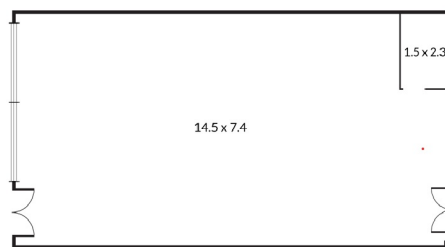

Elders
Commercial

NOTE: Every precaution has been taken to verify the accuracy of the above details. However, prospective purchasers are advised to make their own enquiries.